

COLIN
70" ACRYLIC DOUBLE
ROLL TOP TUB

Cat. No.
 ADRN70LP



L: 70"
 W: 31-3/4"
 H: 24-1/2"

Water depth: 16 1/4" to top of tub
 Water depth: 11-3/4" to OF

The following is recommended for ADRN70LP tubs:

- Faucets: part #4602, 4022 or 4025
- Rigid, freestanding supplies: part #4502
- Leg tub drain: part #5599LT or 5599TS



Overflow can be drilled.
 With overflow drilled this tub requires drain **5599E**.
Tubs that have been drilled with overflow are "special order" and are not returnable.

Gallon Capacity: 57
 Shipping Weight: 162 lbs.
 Empty Weight: 102 lbs.
 Filled Weight: 676 lbs.

Features:

- ▶ Interior and exterior walls acrylic sheets
- ▶ Space between walls partially filled with fiberglass & resin
- ▶ No faucet holes
- ▶ No overflow
- ▶ Aluminum lion paw feet available in 4 finishes
- ▶ Tub is thoroughly inspected before shipment



Feet Finishes:

BN Brushed Nickel
CP Polished Chrome
PB Polished Brass
ORB Oil Rubbed Bronze

Custom Colors Available (inside of tub is always white enamel):
 Painted bathtubs are considered "special order" and are not returnable
 \$160 Bisque or Black \$250 Designer Color

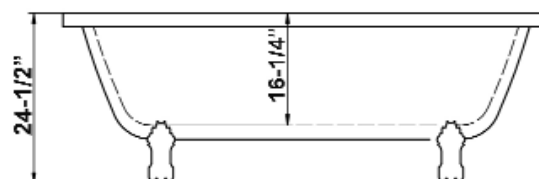
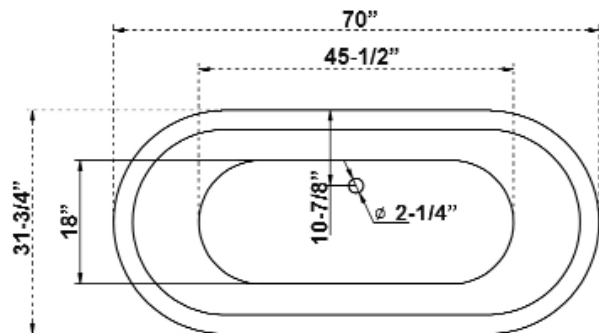

Dimensions of fixture are nominal and specifications subject to change without notice.